

+NOTICE!!

These documents have been scanned!

Do not place un-scanned documents beneath this notice!

Do not remove this notice from this file!

GPO Jacket No. 560-102
Print Order 61549
Rise Business Services, LLC
Job=AZ15 1/8/2020



Box Number= AZ15284



Claim Begin-End: AMC458196-AMC458196

1 Initial Receipt



AZ15284-13

AMC458525-AMC458783

United States Department of the Interior
Bureau of Land Management
 DIV OF LANDS, MINRLS & ENERGY
 ONE N CENTRAL AVE
 PHOENIX, AZ 85004 -4427
 Phone: 602-417-9200

Receipt	
No:	4605782

Transaction #: 4727706	
Date of Transaction: 11/13/2019	
CUSTOMER:	
MICHAEL REID 1546 E DOBBINS RD PHOENIX, AZ 85042-8413 US	

ENTERED

NOV 15 2019

LINE #	QTY	DESCRIPTION	REMARKS	UNIT PRICE	TOTAL
1	1.00	LOCATABLE MINERALS / MINING CLAIMS-NEW, UNADJUD, ONE OR MORE AUTH NOS / NEW MINING CLAIM PROCESSING FEE CASES: AMC458196/\$20.00		- n/a -	20.00
2	1.00	LOCATABLE MINERALS / MINING CLAIMS-NEW, UNADJUD, ONE OR MORE AUTH NOS / NEW MINING CLAIMS LOCATION FEE CASES: AMC458196/\$40.00		- n/a -	40.00
3	1.00	LOCATABLE MINERALS / MINING CLAIMS-NEW, UNADJUD, ONE OR MORE AUTH NOS / NEW MINING CLAIMS MAINTENANCE FEE CASES: AMC458196/\$165.00		- n/a -	165.00
TOTAL:					\$225.00

PAYMENT INFORMATION			
1	AMOUNT:	225.00	POSTMARKED: N/A
	TYPE:	CASH	RECEIVED: 11/13/2019
	NAME:	REID, MICHAEL 1546 E DOBBINS RD PHOENIX AZ 85042-8413 US	

REMARKS

This receipt was generated by the automated BLM Collections and Billing System and is a paper representation of a portion of the official electronic record contained therein.

NOTICE!!

These documents have been scanned!

Do not place un-scanned documents beneath this notice!

Do not remove this notice from this file!

GPO Jacket No. 560-102
Print Order 61549
Rise Business Services, LLC
Job=AZ15 1/8/2020



Box Number= AZ15284



Claim Begin-End: AMC458196-AMC458196

2 Correspondence



AZ15284-13

AMC458525-AMC458783

**NO
DOCUMENTS
FOUND**

NO DOCUMENTS FOUND
NO DOCUMENTS FOUND

NOTICE!!

These documents have been scanned!

Do not place un-scanned documents beneath this notice!

Do not remove this notice from this file!

GPO Jacket No. 560-102
Print Order 61549
Rise Business Services, LLC
Job=AZ15 1/8/2020



Box Number= AZ15284



Claim Begin-End: AMC458196-AMC458196

3 Transfers



AZ15284-13

AMC458525-AMC458783

**NO
DOCUMENTS
FOUND**

NO DOCUMENTS FOUND
NO DOCUMENTS FOUND

NOTICE!!

These documents have been scanned!

Do not place un-scanned documents beneath this notice!

Do not remove this notice from this file!

GPO Jacket No. 560-102
Print Order 61549
Rise Business Services, LLC
Job=AZ15 1/8/2020



Box Number= AZ15284



Claim Begin-End: AMC458196-AMC458196

4 Annual Filings



AZ15284-13

AMC458525-AMC458783

**NO
DOCUMENTS
FOUND**

NO DOCUMENTS FOUND
NO DOCUMENTS FOUND

NOTICE!!

These documents have been scanned!

Do not place un-scanned documents beneath this notice!

Do not remove this notice from this file!

GPO Jacket No. 560-102
Print Order 61549
Rise Business Services, LLC
Job=AZ15 1/8/2020



Box Number= AZ15284



Claim Begin-End: AMC458196-AMC458196

5 Miscellaneous



AZ15284-13

AMC458525-AMC458783

**NO
DOCUMENTS
FOUND**

NO DOCUMENTS FOUND
NO DOCUMENTS FOUND

NOTICE!!

These documents have been scanned!

Do not place un-scanned documents beneath this notice!

Do not remove this notice from this file!

GPO Jacket No. 560-102
Print Order 61549
Rise Business Services, LLC
Job=AZ15 1/8/2020



Box Number= AZ15284



Claim Begin-End: AMC458196-AMC458196

6 Location Notices-Amendments and Supporting Documents

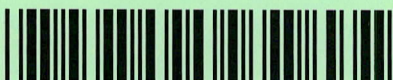

AZ15284-13

AMC458525-AMC458783

MINING CLAIM STATUS REPORT - Assessment Year 2020

Data Entered: 11/15/19 AM

MTP Checked By: Jme
GEO Checked By: Jme

LEAD SERIAL NUMBER: AMC 458196 thru AMC _____

NUMBER OF CLAIMS & TYPE:	CHARGES:
<u>1</u> LODE	Processing Fee @ \$20 = \$ <u>20</u>
_____ PLACER	Location Fee @ \$40 = \$ <u>40</u>
_____ ASSOCIATION PLACER	Maintenance Fee @ \$165 = \$ <u>105</u>
_____ MILL SITE	Add'l Maint Fee for Assoc Placer = \$ _____
_____ TUNNEL SITE	SUBTOTAL \$ _____
TOTAL ACREAGE: _____ Per Claim	Other Fees \$ _____
(Placer Only)	Other Fees \$ _____
NUMBER OF LOCATORS: _____	TOTAL \$ <u>225</u>

DOCUMENTS RECEIVED VIA : Over-the-Counter Mail **TIMELY FILED:** Yes No

LEGAL DESCRIPTION: T 12N R 2W SEC 12
T _____ R _____ SEC _____
T _____ R _____ SEC _____
T _____ R _____ SEC _____
T _____ R _____ SEC _____

BLM FOREST SERVICE _____ SUBJ TO PL 359: Yes No
WILDERNESS AREA _____

SPLIT ESTATE: N/A SX PX OTHER _____
SRHA Was proper Notice filed if located on SHRA Land? Yes No

RECONVEYED MINERALS ON BLM LAND REQUIRE OPENING ORDER FROM 1944 TO 1993:
Open to Entry On _____ N/A

COMMENTS/STATUS: VOID PARTIALLY VOID PVT MINERALS WITHDRAWN LANDS
OTHER _____

[] Claimant acknowledges that portions of the following claim(s) site(s) may be void or voidable.

Printed Name of Claimant _____ Signature of Claimant _____

*****FINAL ADJUDICATION*****

DATE _____ INITIALS _____

LOCATION NOTICE FOR LODE MINING CLAIM

Amendment BLM Serial # _____

NOTICE IS HEREBY GIVEN that the EASY TO GET
_____ lode mining claim has been located
by LUKE SIEKMANN + MICHAEL REID whose current mailing
address is 1546 E. DOBBINS RD, PHOENIX, ARIZONA
85042

RECEIVED
LM AZ STATE OFFICE
2019 NOV 13 A 9:28
PHOENIX, ARIZONA
BLM
Date
Stamp

The general course of this claim is NORTH TO SOUTH and it is situated in YAVAPAI
County, Arizona. This claim is 1500 feet in length and 600 feet in width.

20.66 Total Claim Acreage. This claim runs from the location monument on which this location notice
is posted on the centerline of the claim approximately 1500 feet in a SOUTH direction to the SOUTH
end line and 0 feet in a NORTH direction to the NORTH end line. This claim is marked by six
monuments, one at each corner and one at the center of each end line of the claim.

The location monument on which this notice is posted is situated within Section 12, Township 12N
_____, Range 2W _____, Gila Salt River Base and Meridian, Arizona and this claim encompasses portions
of the following quarter section(s), section(s), Township(s) and Range(s) NE 1/4, SW 1/4 SEC. 12 T12N R2W

Gila Salt River Base and Meridian, Arizona.

The locality of this claim with reference to some natural object or permanent monument and additional information
(if any) concerning its locality are as follows: APPROXIMATELY 3960 FEET FROM THE NW CORNER
OF THE EASY TO GET CLAIM TO THE NW CORNER OF SECTION 12 T12N R2W IN A
RELATIVE DIRECTION 327 DEGREES TRUE The above information is shown on the attached map.

DATED AND POSTED on the ground this 10th day of NOVEMBER, 20 19.

LOCATOR(s) AGENT

Print Name(s) LUKE SIEKMANN + MICHAEL REID

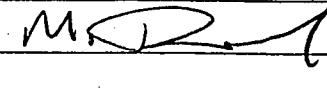
Signature(s)  

Form MCF100
Revised July 2014

This form is available from the Arizona Geological Survey and may be reproduced.

AHC 458196

112° 25' 59.05" W
33° 24' 32.50" N
(PRESCOTT)
112° 26' 47.37" W
33° 24' 32.50" N

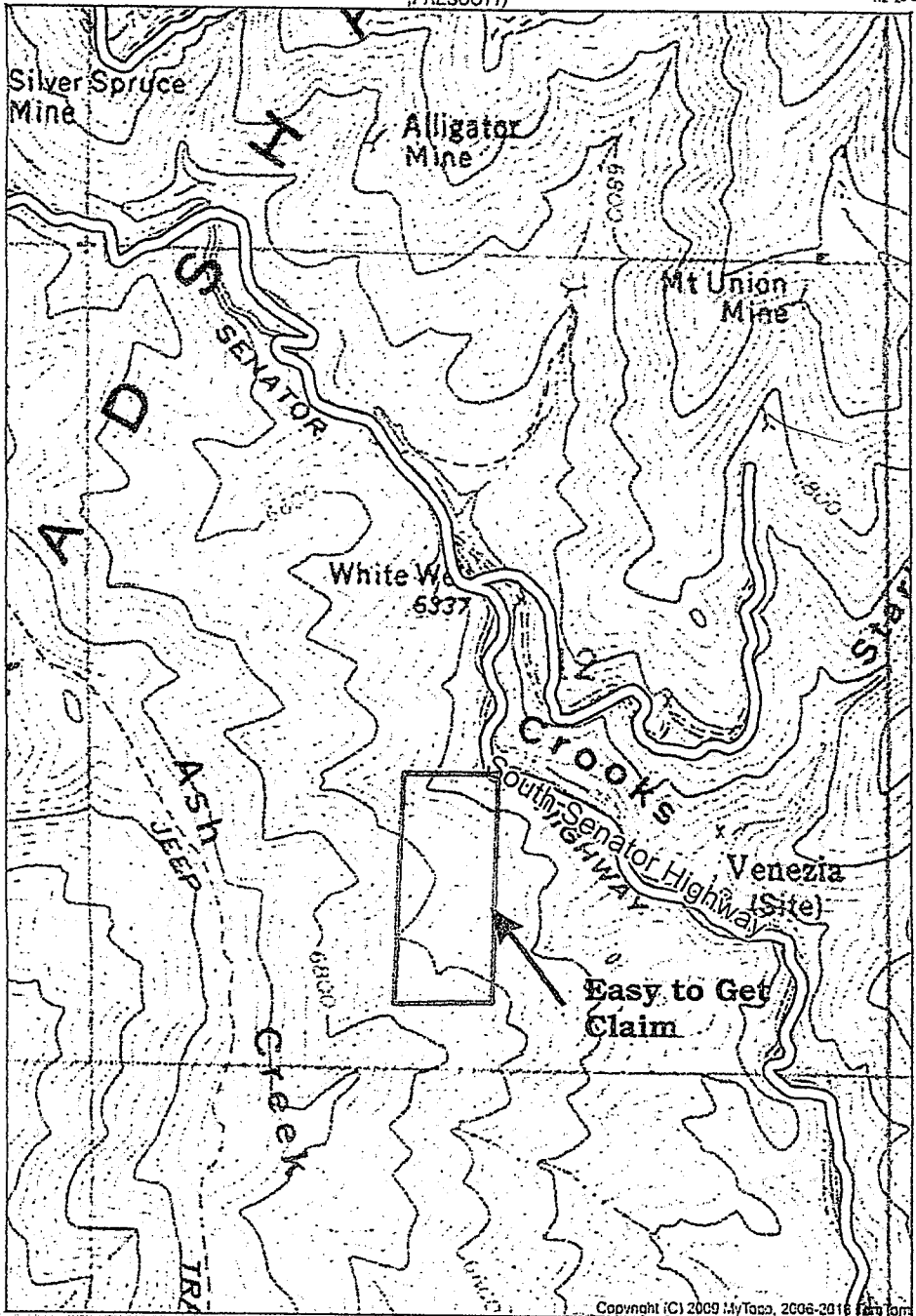

Easy to Get
Lode Claim

T12N R2W
Section 12
NE, SW

RECEIVED
LMAZ STATE OFFICE
2019 NOV 13 A 9:28
HOENIX, ARIZONA
(FBI AND JUSTICE)

(WILHOIT)
(WALNUT GROVE)

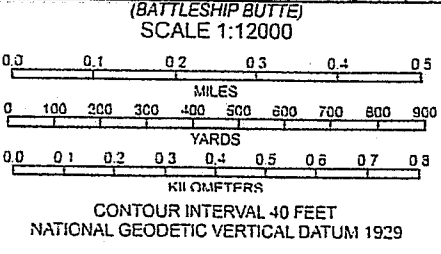

GROOM CREEK, AZ.
1974

Produced by MyTopo Terrain Navigator
Topography based on USGS 1:24,000
Maps

North American 1983 Datum (NAD83)
Transverse Mercator Projection

To place on the predicted North American
1927 move the projection files 3M N and
0721 W

AN0458196

Easy to Get lode claim location in T12N R2W Section 12 NE, NW
Corners are marked with 2x2 wooden posts 4 foot above grade
Location post for Easy to Get is the North Central Post

▲ **Purpose**

This report produces a geographic listing of case information based on retrieval by Meridian/Township/Range. This report format will display the case type, case disposition, meridian, township, range, section, survey type, survey number, surface management agency, pending actions, serial number, and total case acres. The report produces listings of cases based on a combination of required and optional criteria.

Report



No Results

The specified criteria didn't result in any data. This is often caused by applying filters and/or selection steps that are too restrictive or that contain incorrect values. Please check your analysis filters and selection steps, and try again. The filters or selection steps currently being applied are shown below.

Filters

Case Suppression Flag is equal to / is in **N**
and Meridian Township Range Section is equal to **14 0120N 0020W 012**
and Admin State is equal to **AZ**

[Return - Refresh](#)

TOWNSHIP 12 NORTH RANGE 2 WEST OF THE GILA AND SALT RIVER MERIDIAN, ARIZONA

YAVAPAI COUNTY

STATUS OF PUBLIC DOMAIN
LAND AND MINERAL TITLES
AND ACQUIRED LANDS
**MTP
SUPPL SECS 1,2,11,12**

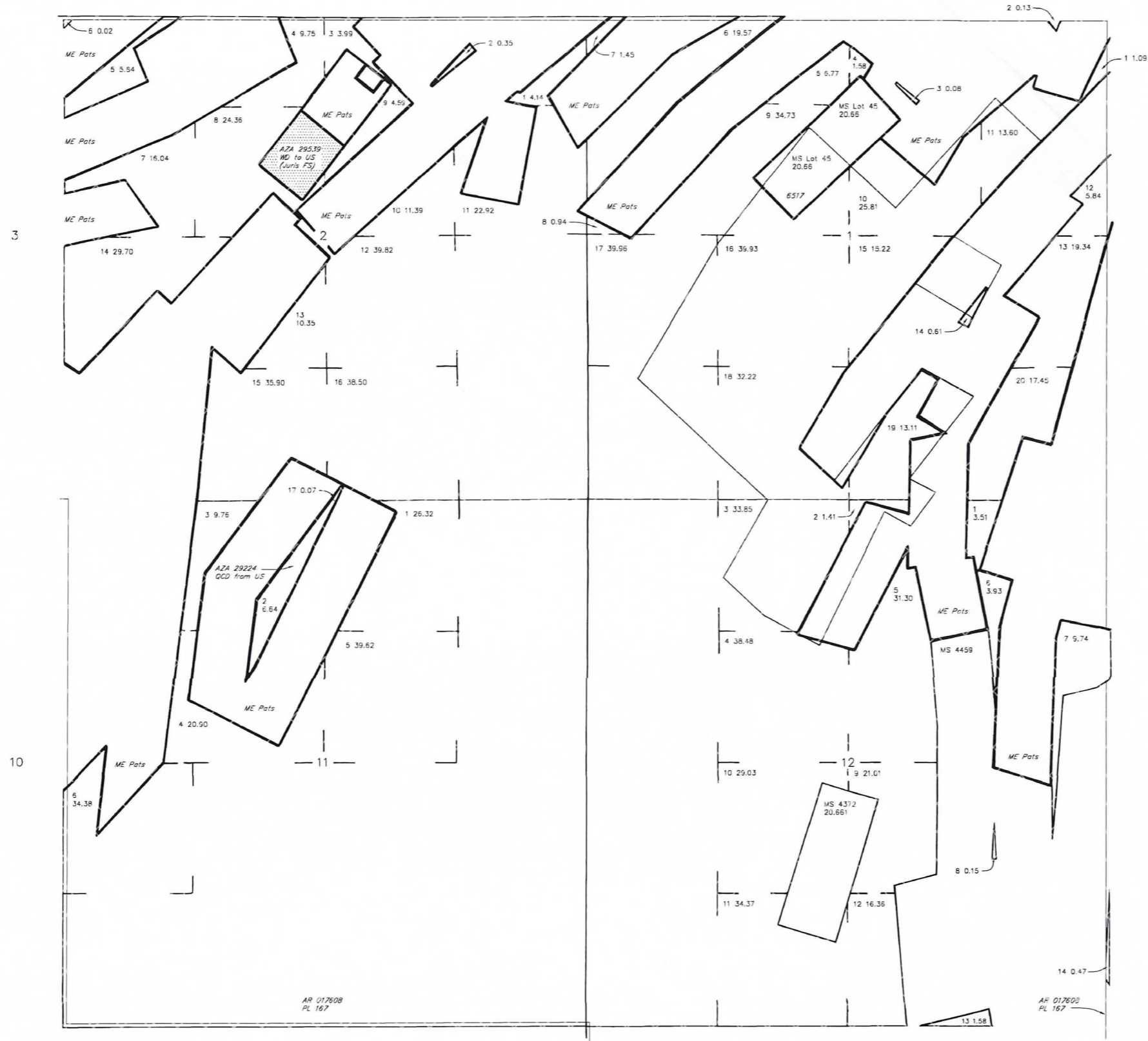

INDEX TO SEGREGATED TRACTS				
RESURVEY TRACT NO	ORIGINAL SURVEY			
	T	R	SEC	SUBDIVISION

FOR ORDERS AFFECTING DISPOSAL OR USE OF UNIDENTIFIED LANDS WITHDRAWN FOR CLASSIFICATION, MINERALS, WATER AND/OR OTHER PUBLIC PURPOSES, REFER TO INDEX OF MISCELLANEOUS DOCUMENTS.

DIST NO 2
MDS 241 NE
All Tp included in Wdl Prescott NF Proc 6, 10/21/1899
AZA 29496 QCD from US (FS) (0.272A)
Sec 2 : Lot 12 (part)

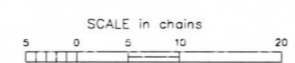

WARNING STATEMENT
This plot is the Bureau's Record of Title, and should be used only as a graphic display of the township survey data. Records hereon do not reflect title changes which may have been effected by lateral movements of rivers or other bodies of water. Refer to the cadastral surveys for official survey information.

CURRENT TO	BT	GSR Mer
11-7-2007	PV	T 12 N
		R 2 W

NO 1

